

RGL10

Elevator traction machine

Voltage : 380V
 Suspension : 2 : 1
 PZ1400B Brake : DC110V 2×0.82A
 Weight : 245kg
 Max.Static Load : 3000kg

Spec	Load (kg)	Lift Speed (m/s)	Sheave Diam(mm)	Rope Sheave (mm)	Current (A)	Torque (Nm)	Rated Speed (rpm)	Frequency (Hz)	Power (kW)	Pole	Rating	INS.Class	IP Code	Length L	Length L1	Length L2	Length L3
RGL10-61P0A	630	1.0	Φ320	5×Φ8×12	9.5	318	120	20	4.0	20	S5(40%)	F	IP41	604	62	110	350
RGL10-61P5A	630	1.5	Φ320	5×Φ8×12	15	330	179	29.8	6.2	20	S5(40%)	F	IP41	604	62	110	350
RGL10-61P6A	630	1.6	Φ320	5×Φ8×12	15	330	192	32	6.6	20	S5(40%)	F	IP41	604	62	110	350
RGL10-61P7A	630	1.75	Φ320	5×Φ8×12	15.8	330	209	34.8	7.2	20	S5(40%)	F	IP41	604	62	110	350
RGL10-62P0A	630	2.0	Φ320	5×Φ8×12	18	330	239	39.8	8.3	20	S5(40%)	F	IP41	604	62	110	350
RGL10-81P0A	800	1.0	Φ320	6×Φ8×12	14	401	120	20	5.0	20	S5(40%)	F	IP41	604	62	110	350
RGL10-81P5A	800	1.5	Φ320	6×Φ8×12	20.2	420	179	29.8	7.9	20	S5(40%)	F	IP41	604	62	110	350
RGL10-81P6A	800	1.6	Φ320	6×Φ8×12	20.2	420	192	32	8.4	20	S5(40%)	F	IP41	604	62	110	350
RGL10-81P7A	800	1.75	Φ320	6×Φ8×12	21.7	420	209	34.8	9.2	20	S5(40%)	F	IP41	604	62	110	350
RGL10-82P0A	800	2.0	Φ320	6×Φ8×12	23.6	420	239	39.8	10.5	20	S5(40%)	F	IP41	604	62	110	350
RGL10-101P0A 1000/1050 1.0			Φ320	7×Φ8×12	17.6	506	120	20	6.4	20	S5(40%)	F	IP41	604	62	110	350
RGL10-101P5A 1000/1050 1.5			Φ320	7×Φ8×12	26	525	179	29.8	9.8	20	S5(40%)	F	IP41	604	62	110	350
RGL10-101P6A 1000/1050 1.6			Φ320	7×Φ8×12	26	525	192	32	10.6	20	S5(40%)	F	IP41	604	62	110	350
RGL10-101P7A 1000/1050 1.75			Φ320	7×Φ8×12	27.5	525	209	34.8	11.5	20	S5(40%)	F	IP41	604	62	110	350
RGL10-102P0A 1000/1050 2.0			Φ320	7×Φ8×12	29.4	525	239	39.8	13.1	20	S5(40%)	F	IP41	604	62	110	350
RGL10-81P0B 800		1.0	Φ240	8×Φ6.5×12	13.5	310	159	26.5	5.2	20	S5(40%)	F	IP41	640	75	133	330
RGL10-81P5B 800		1.5	Φ240	8×Φ6.5×12	20.0	310	239	39.8	7.8	20	S5(40%)	F	IP41	640	75	133	330
RGL10-81P6B 800		1.6	Φ240	8×Φ6.5×12	21.5	310	255	42.5	8.3	20	S5(40%)	F	IP41	640	75	133	330
RGL10-81P7B 800		1.75	Φ240	8×Φ6.5×12	21.5	310	279	46.5	9.1	20	S5(40%)	F	IP41	640	75	133	330
RGL10-101P0B 1000/1050 1.0			Φ240	9/10×Φ6.5×12	16.6	380	159	26.5	6.3	20	S5(40%)	F	IP41	640	75	133	330
RGL10-101P5B 1000/1050 1.5			Φ240	9/10×Φ6.5×12	24.5	380	239	39.8	9.5	20	S5(40%)	F	IP41	640	75	133	330
RGL10-101P6B 1000/1050 1.6			Φ240	9/10×Φ6.5×12	26.3	380	255	42.5	10.1	20	S5(40%)	F	IP41	640	75	133	330
RGL10-101P7B 1000/1050 1.75			Φ240	9/10×Φ6.5×12	26.3	380	279	46.5	11.1	20	S5(40%)	F	IP41	640	75	133	330

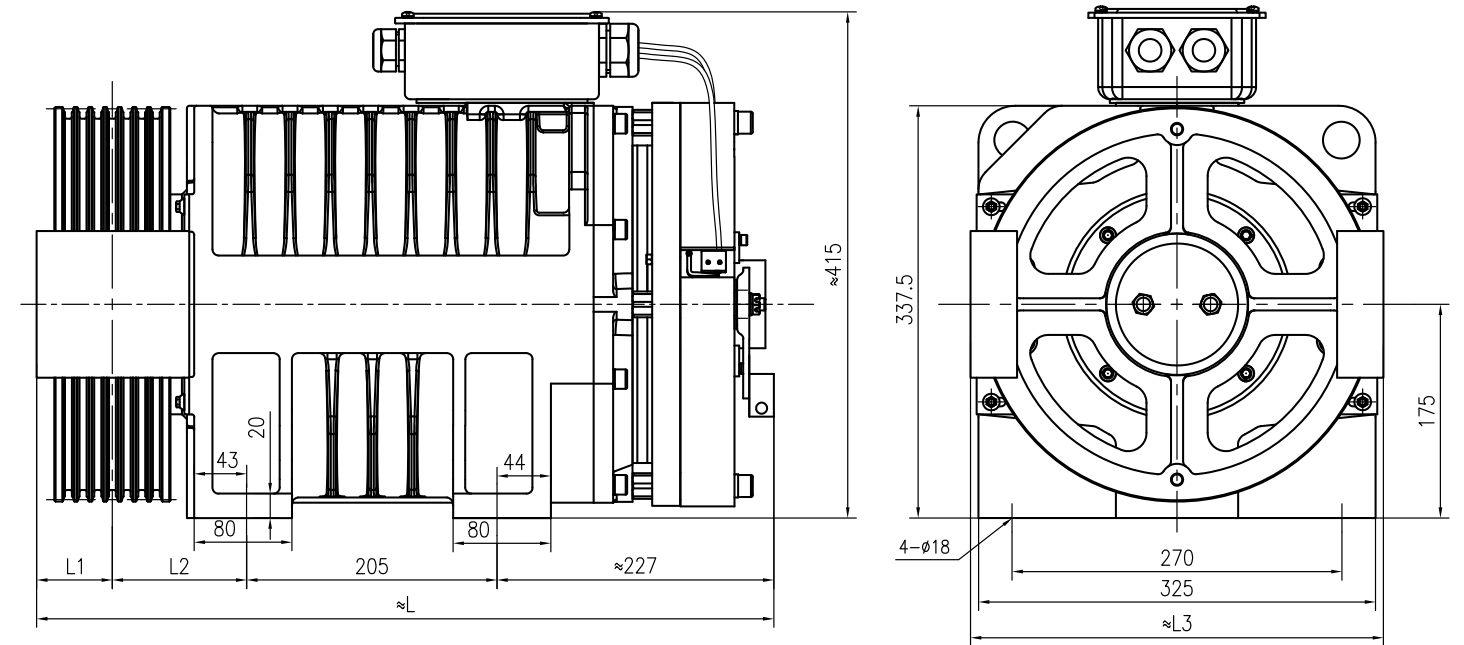

REMARK

The standard configuration of this machine does not include manual brake release, The manual brake release is optional.